



*Profiles Design Aspirer*

**PDA**

**70SD BRASS** DOOR/WINDOW SYSTEM

**COLOR EFFECT :**

Brass windows possess a distinctive texture and hue, and their surfaces can be subjected to dyeing or painting treatments to enhance their artistic character and aesthetic appeal.

**CLASSIC AND AESTHETIC:**

Brass windows exhibit a magnificent and elegant style, contributing unique character and texture to the architecture. As they age, they acquire a vintage patina that enhances the building's historical value.

**DURABILITY**

Brass is a robust and durable metal with exceptional corrosion and wear resistance. Compared to other materials, brass windows provide superior longevity while retaining their aesthetic appeal.



**HIGH STABILITY**

Brass possesses stable physical properties and is resistant to deformation, ensuring long-term structural integrity in windows.

**GOOD MACHINABILITY**

Brass offers excellent machinability, enabling the production of intricate shapes and patterns to satisfy various design needs.

**LOW OVERALL MAINTENANCE COSTS**

Brass windows necessitate minimal maintenance, and the application of specialized brass paint can effectively prolong their lifespan

**HIGH SAFETY**

Brass windows are robust and reliable, providing excellent anti-theft features that enhance building security.

7025 BRASS WINDOW NODE DETAILS

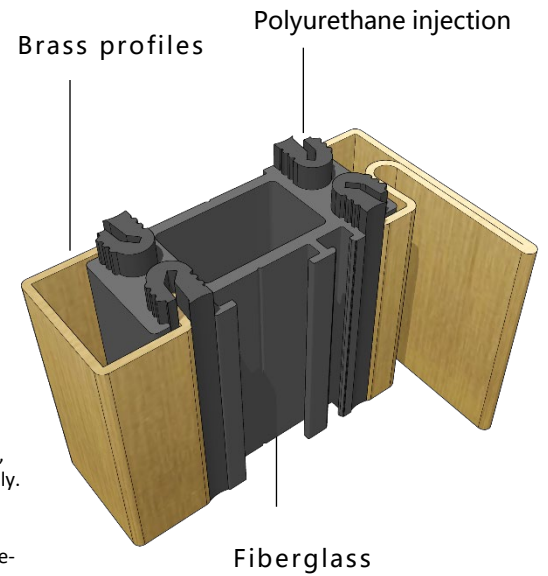
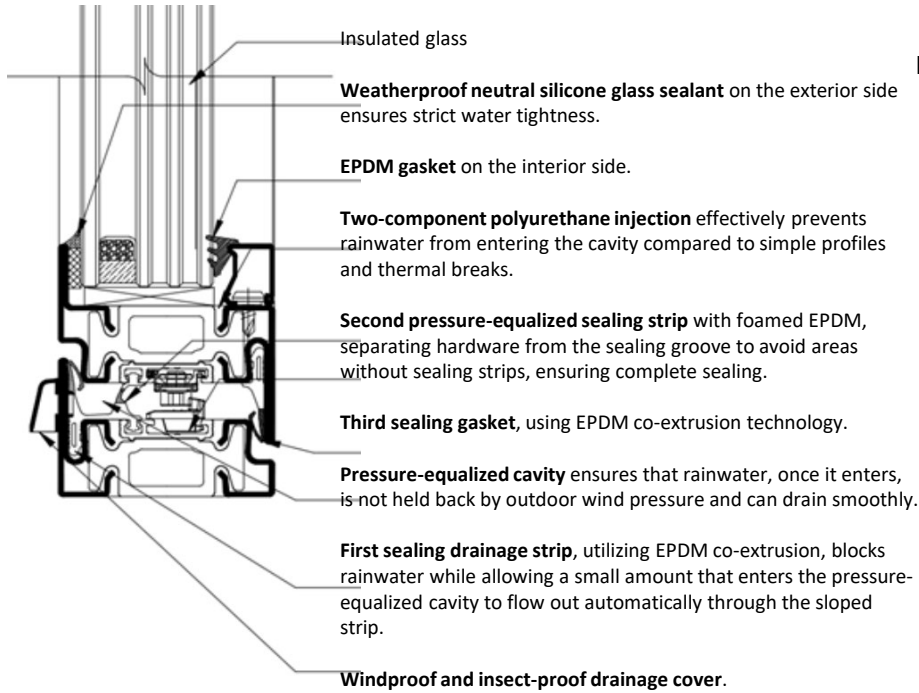

The image is sourced from the internet or third parties and is for reference only.

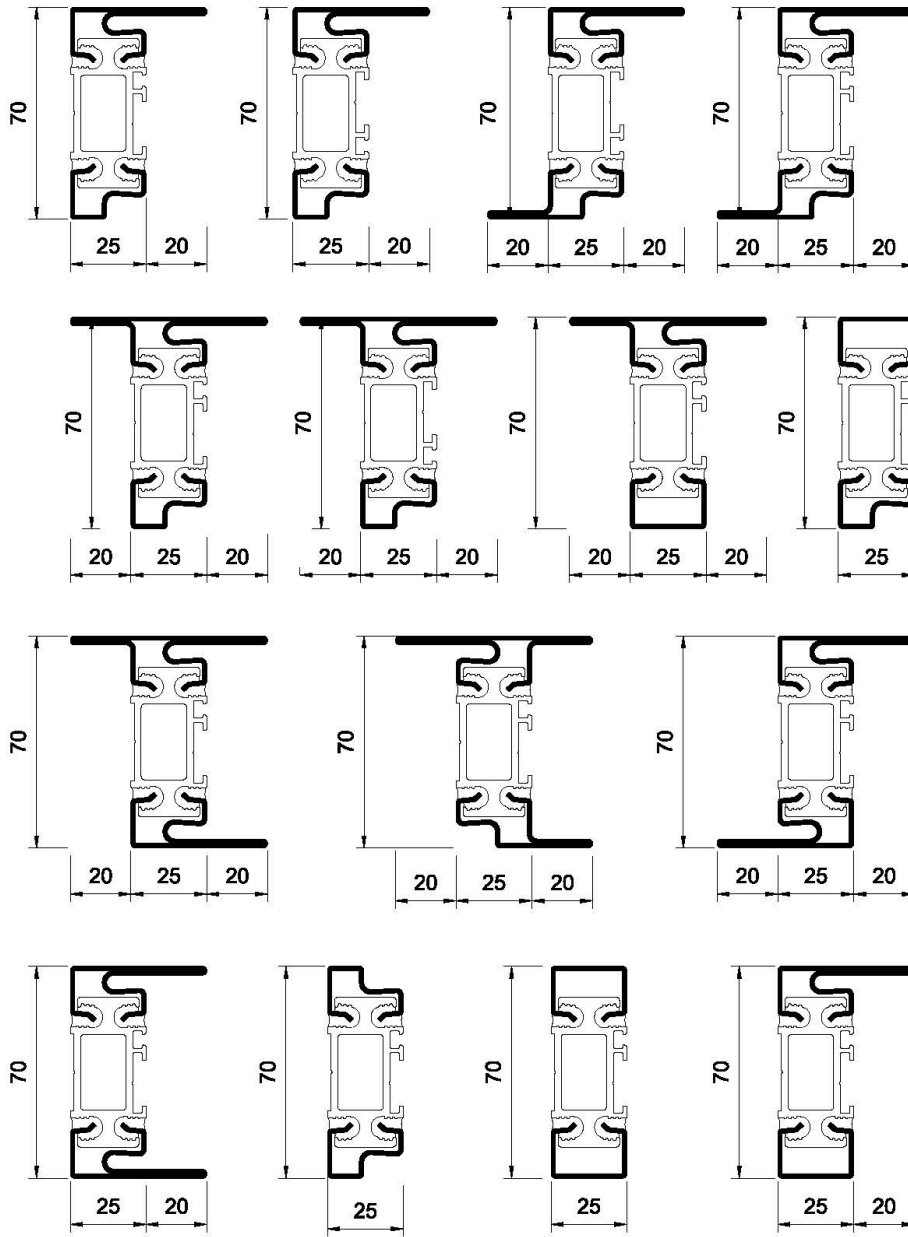

7025 BRASS PROFILES

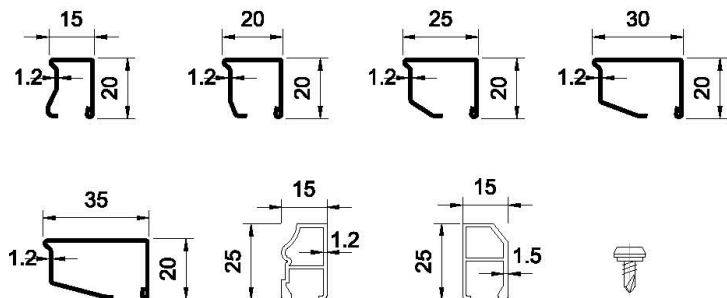

7025 BRASS GLAZING BEAD



The image is sourced from the internet or third parties and is for reference only.



The image is sourced from the internet or third parties and is for reference only.

Handle for 7025 Brass Window System





PDA website: [www.international-pda.com](http://www.international-pda.com)

contact: International Business Manager: Yini Tao

E-mail: [taoyini@eng-pda.com](mailto:taoyini@eng-pda.com)

Marketing Manager: Nancy Zhao

E-mail: [zhn@eng-pda.com](mailto:zhn@eng-pda.com)